

LEGEND

- ◇----- ORIGINAL GOVERNMENT CORNER SEARCHED FOR - NOT FOUND
- ◆----- ORIGINAL GOVERNMENT CORNER FOUND
- ◆----- FOREST SERVICE CORNER
- ◆----- STANDARD B.L.M. CORNER
- ◆----- STANDARD D.W.R. CORNER
- ◆----- STANDARD BUTTE CORNER - 2" IRON PIPE AND BRASS CAP
Disc Brass Cap
- CORNER MONUMENT - NO HISTORY - SHOWN ON RECORD MAP
- CORNER MONUMENT - NO HISTORY
- ORIGINAL CORNER MONUMENT - SHOWN ON RECORD MAP
- PROPORTIONED CORNER SET BY SURVEYOR - SHOWN ON RECORD MAP
- CORNER MONUMENT SET BY SURVEYOR - NOT SHOWN ON RECORD MAP
- CORNER SEARCHED FOR NOT FOUND - DATE OF SEARCH
-

NOTES

- 32-PM-25 ----- BOOK 32 OF PARCEL MAPS PAGE 25
- 32-RS-25 ----- BOOK 32 OF RECORD OF SURVEY MAPS PAGE 25
- 32-S-25 ----- BOOK 32 OF MAPS (SUBDIVISION) PAGE 25
- 114-FB-25 ----- BOOK 114 PAGE 25 OF COUNTY SURVEY FIELD NOTES
- C-506 ----- MAP ON FILE PUBLIC WORKS DEPARTMENT
- CR ----- CORNER RECORD FILED
- PS ----- PRIVATE SURVEYORS INFORMATION
- M.O.R. ----- MOUND OF ROCKS

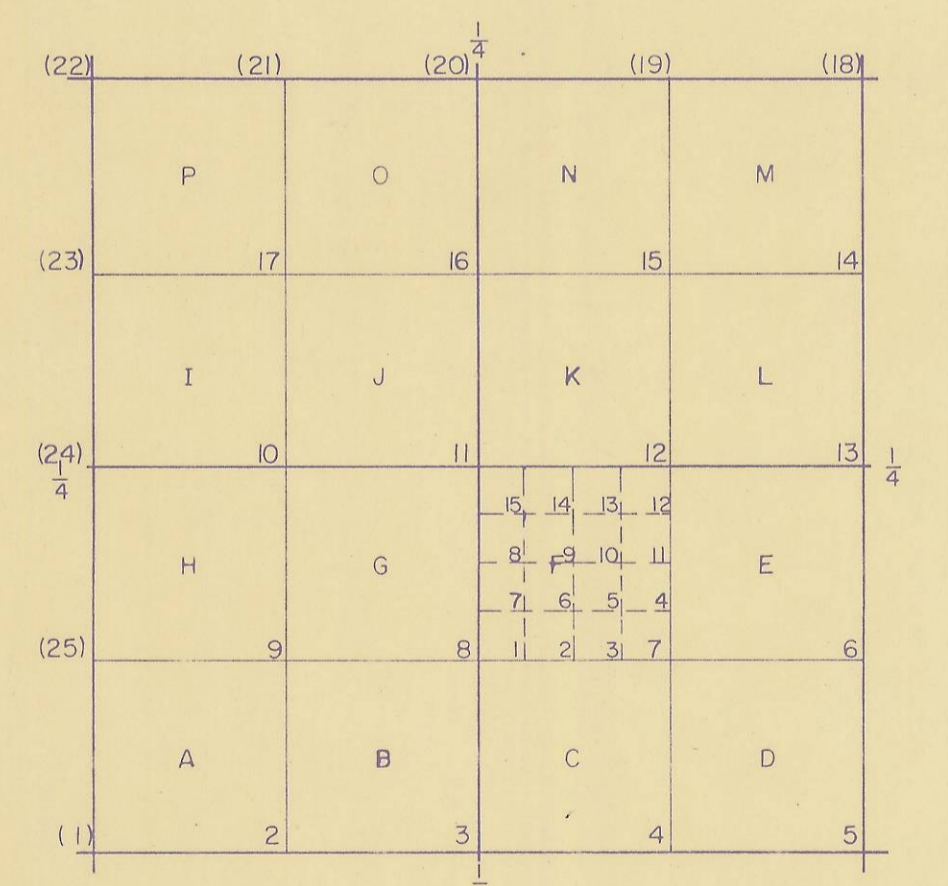

Section Corner Index Typical
 (1) - Special case
 EXAMPLE:
 18-3 = South 1/4 corner of Section 18
 18-F-9 = Center of NW 1/4 of SE 1/4 of Section 18

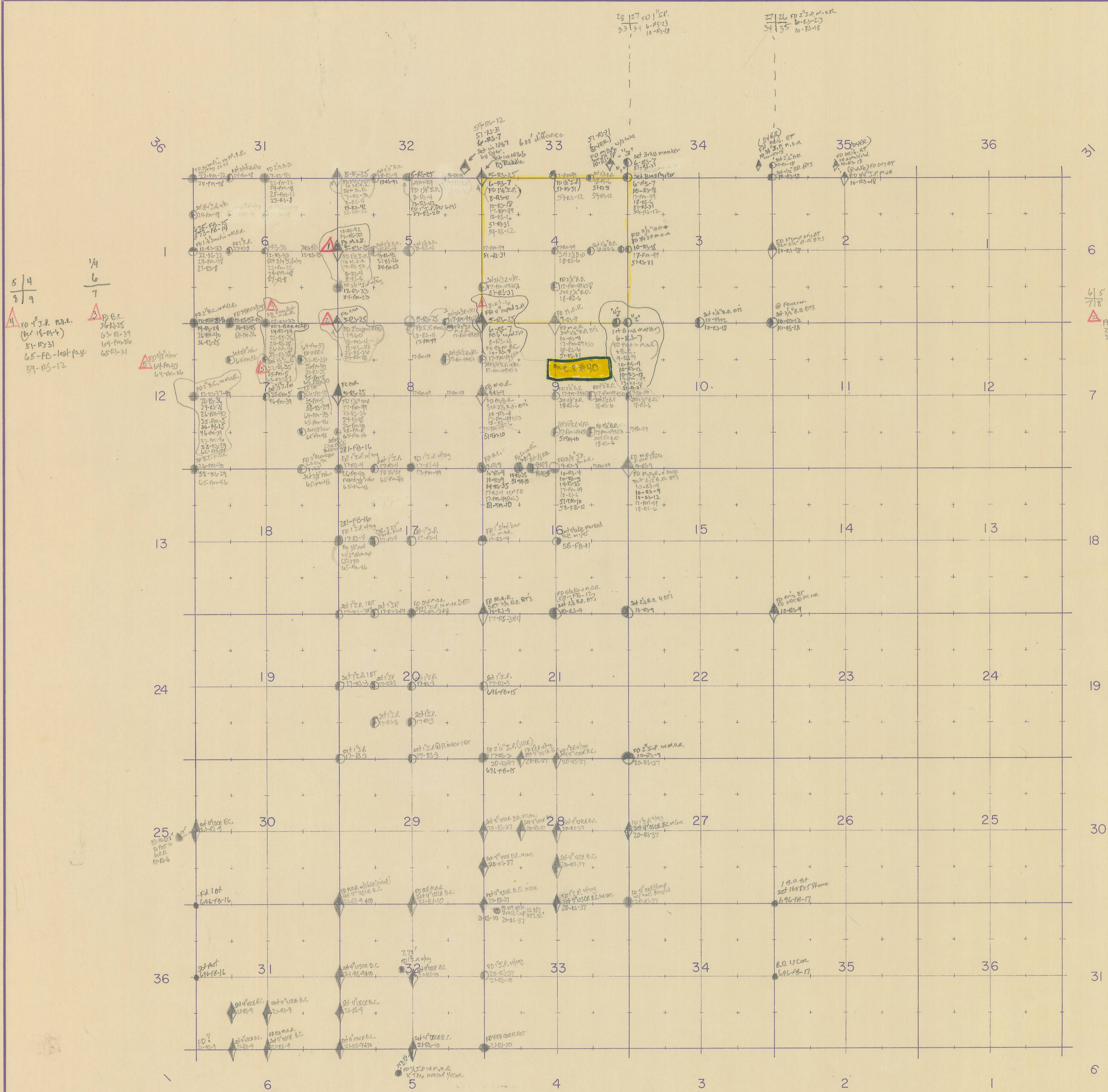

5/4
8/9
1/4
6/7

FD 432 N.M.T.
(B.L.M. 18-18-1)
51-PS-31
65-FB-10st-10st
59-PS-12

FD B.C.
26-PS-25
63-PS-39
64-PS-36
68-PS-31

FD 1/2 S. R. M.O.R. @ P.C.
21-PS-26
25-PS-11
27-PS-8
34-PS-23
35-PS-12
57-PS-18-15
67-PS-71

FD 3/4 S. R. M.O.R. @ P.C.
26-PS-10
30-PS-35

Date of last entry _____

COUNTY OF YUBA
 DEPARTMENT OF PUBLIC WORKS
 MARYSVILLE CALIFORNIA

Section Corner Monumentation
 T. 17 N. - R. 7 E. - M.D.B. # M.

DWN. BY	DATE	PROJECT NUMBER
CHK. BY	DATE	
F.B.	SCALE 1" = 2000'	